

Šest'hranný hadicový nádstavec

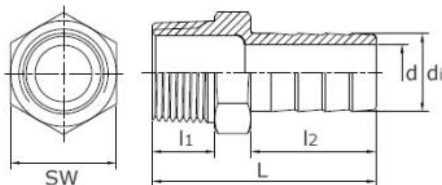

Technický list výrobku

Rozmer	L	I1	I2	di	d	SW	kg
1/8"	29	10	17	7,0	3	11	0,008
1/4"	40,5	11	23	9,0	5	15	0,018
3/8"	40,5	12	23	11,0	8	18	0,023
1/2"	48	16	28	13,0	9	22	0,036
3/4"	51	14	28	20,0	16	28	0,059
1"	62	17	36	25,0	20	35	0,097
5/4"	64	20	36	33,0	29	44	0,151
6/4"	75	20	44	39,0	34	49	0,205
2"	79	26	44	51,0	46	62	0,315
2 1/2"	97	28	61	63,0	55	76	0,972
3"	115	31	74	76,5	70	90	1,384
4"	116	35	72	101,5	93	115	2,908

Akost: 1.4404