

Privarovacia vsuvka z nerezovej ocele /NIPEL/

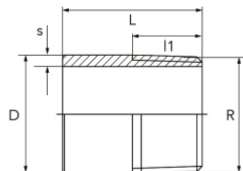

Technický list výrobku

Rozmer	D	L	I1	s	kg
1/8"	10,2	30	8,0	2,00	0,013
1/4"	13,5	30	11,0	2,35	0,020
3/8"	17,2	30	12,0	2,35	0,023
1/2"	21,3	35	15,0	2,65	0,040
3/4"	26,9	40	17,0	2,65	0,060
1"	33,7	40	20,0	3,25	0,082
5/4"	42,4	50	22,0	3,25	0,139
6/4"	48,3	50	22,0	3,25	0,150
2"	60,3	50	26,0	3,65	0,220
2 1/2"	76,1	60	28,0	3,65	0,360
3"	88,9	65	35,0	4,05	0,420
4"	114,3	80	42,0	4,00	0,740
5"	139,7	90	48,0	5,00	1,150
6"	168,3	100	50,0	6,50	2,283

Akost: 1.4404